

SKETCH/AREA TABLE ADDENDUM

NAME 8/8/07

RE # 2964206

SUBJECT

PARCEL ID 29-37-30-UX-145			
CITY PALM BAY	COUNTY Brevard	STATE FL	ZIP 32909
PERMIT # N/A			
MARKET AREA 14	ADDRESS 419 Easton Forest		
APPRAISER NAME GLG	BRANCH OFFICE PALM BAY		

IMPROVEMENTS SKETCH

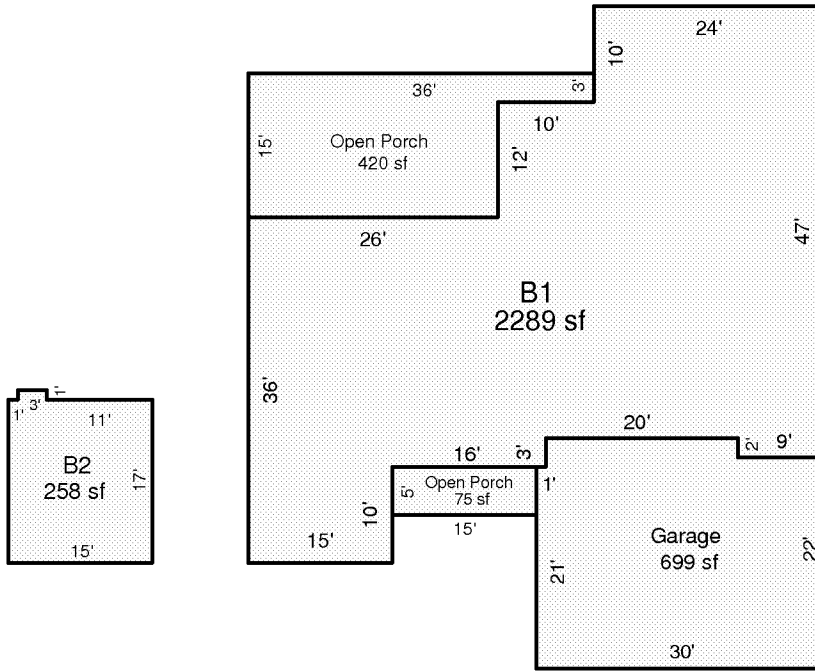

AREA CALCULATIONS

AREA CALCULATIONS SUMMARY

Code	Description	Factor	Net Size	Perimeter	Net Totals
B1	B1	1.00	2289	240	2289
B2	B2	1.00	258	66	258
GA	Garage	1.00	699	108	699
OP	Open Porch	1.00	75	40	
	Open Porch	1.00	420	102	495

Comment Table 1

--	--

Comment Table 2

Comment Table 3

--	--