

SKETCH/AREA TABLE ADDENDUM

DATE 10/14/10

RE # 2959552

SUBJECT

PARCEL ID	29-38-36-28-*15		
CITY	Melbourne Beach	COUNTY	Brevard
		STATE	FL
		ZIP	32951
PERMIT #	R		
MARKET AREA	20	ADDRESS	901 Aquarina Blvd.
APPRAISER NAME	GAC	BRANCH OFFICE	PALM BAY

IMPROVEMENTS SKETCH

*NO ON SITE MEASUREMENTS CHECKED. PICTOMETRY EST

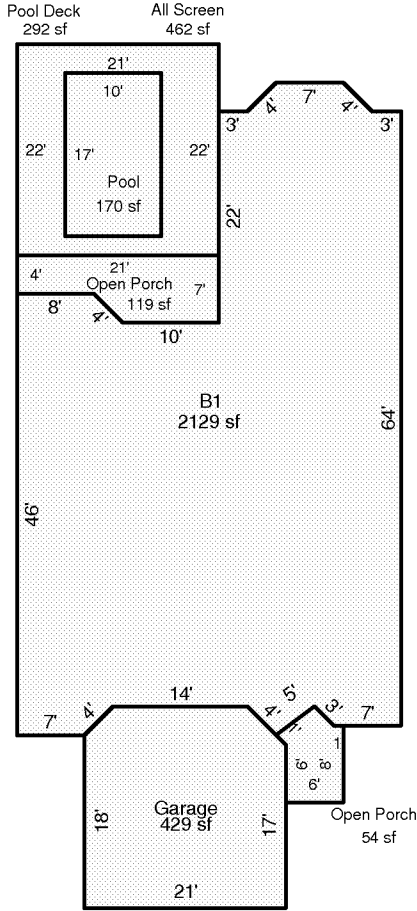

Scale: 1 = 20

AREA CALCULATIONS

AREA CALCULATIONS SUMMARY

Code	Description	Factor	Net Size	Perimeter	Net Totals
B1	B1	1.00	2129	220	2129
GA	Garage	1.00	429	80	429
OP	Open Porch	1.00	54	30	
	Open Porch	1.00	119	54	172
ALSCN	All Screen	1.00	462	86	462
PDECK	Pool Deck	1.00	292	86	292
POOL	Pool	1.00	170	54	170

Comment Table 1

Comment Table 2

Comment Table 3