

SKETCH/AREA TABLE ADDENDUM

DATE 10/14/10

RE # 2959544

SUBJECT

PARCEL ID 29-38-36-28*-9	COUNTY Brevard	STATE FL	ZIP 32951
CITY Melbourne Beach	ADDRESS 915 Aquarina Blvd.		
PERMIT # R	BRANCH OFFICE PALM BAY		
MARKET AREA 20			

*NO ON SITE MEASUREMENTS CHECKED. PICTOMETRY EST

IMPROVEMENTS SKETCH

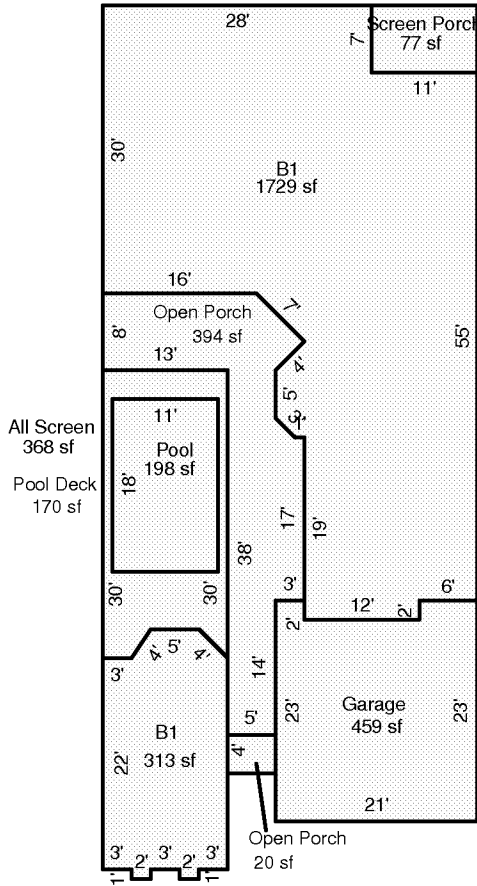

Scale: 1 = 20

AREA CALCULATIONS

AREA CALCULATIONS SUMMARY

Code	Description	Factor	Net Size	Perimeter	Net Totals
B1	B1	1.00	1729	206	
B1	B1	1.00	313	77	2042
GA	Garage	1.00	459	92	459
OP	Open Porch	1.00	394	134	
OP	Open Porch	1.00	20	18	414
SP	Screen Porch	1.00	77	36	77
ALSCN	All Screen	1.00	368	89	368
PDECK	Pool Deck	1.00	170	89	170
POOL	Pool	1.00	198	58	198

Comment Table 1

Comment Table 1	
-----------------	--

Comment Table 2

Comment Table 3

Comment Table 2	Comment Table 3
-----------------	-----------------