

SKETCH/AREA TABLE ADDENDUM

DATE 2/3/11

RE # 29595341

SUBJECT

| | | | |
|--|--------------------------|----------|-----------|
| PARCEL ID 29-38-23-00-21 | COUNTY BREVARD | STATE FL | ZIP 32949 |
| CITY VALKARIA | ADDRESS 6360 HIGHWAY A1A | | |
| PERMIT # SFR 12-8-99 OCOO91623 \$112,000 | BRANCH OFFICE PALM BAY | | |
| MARKET AREA 015 | | | |

IMPROVEMENTS SKETCH

NO F/C ALL ESTIMATED W/PICTOMETRY

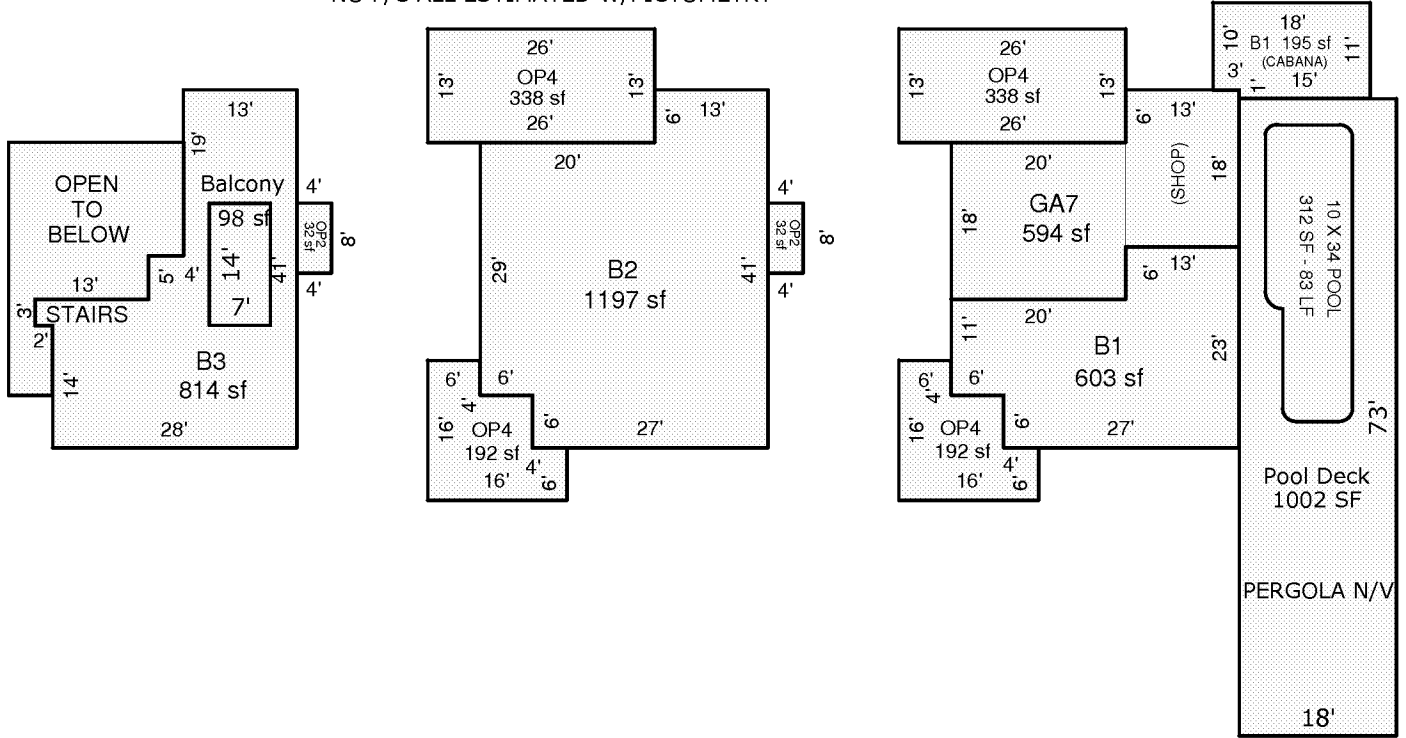

Scale: 1 = 22

AREA CALCULATIONS

AREA CALCULATIONS SUMMARY

| Code | Description | Factor | Net Size | Perimeter | Net Totals |
|-------|-------------|--------|----------|-----------|------------|
| B1 | B1-100 | 1.00 | 603 | 112 | |
| | B1-100 | 1.00 | 195 | 58 | 798 |
| B2 | B2-100 | 1.00 | 1197 | 148 | 1197 |
| B3 | B3-100 | 1.00 | 814 | 142 | 814 |
| BC | Balcony | 1.00 | 98 | 42 | 98 |
| PDECK | Pool Deck | 1.00 | 1314 | 182 | 1314 |
| OP4 | OP-30 | 1.00 | 338 | 78 | |
| | OP-30 | 1.00 | 192 | 64 | |
| | OP-30 | 1.00 | 338 | 78 | |
| | OP-30 | 1.00 | 192 | 64 | 1060 |
| OP2 | OP-20 | 1.00 | 32 | 24 | |
| | OP-20 | 1.00 | 32 | 24 | 64 |
| GA7 | GA-60 | 1.00 | 594 | 114 | 594 |

| | |
|--|--|
| | |
| | |
| | |