

SKETCH/AREA TABLE ADDENDUM

DATE 10/20/10

RE # 2958781

SUBJECT

PARCEL ID 29-38-36-26*-3			
CITY Melbourne Beach	COUNTY Brevard	STATE FL	ZIP 32951
PERMIT # R			
MARKET AREA 20	ADDRESS 384 Aquarina Blvd		
APPRAISER NAME GAC	BRANCH OFFICE PALM BAY		

IMPROVEMENTS SKETCH

*NO ON SITE MEASUREMENTS CHECKED. PICTOMETRY EST

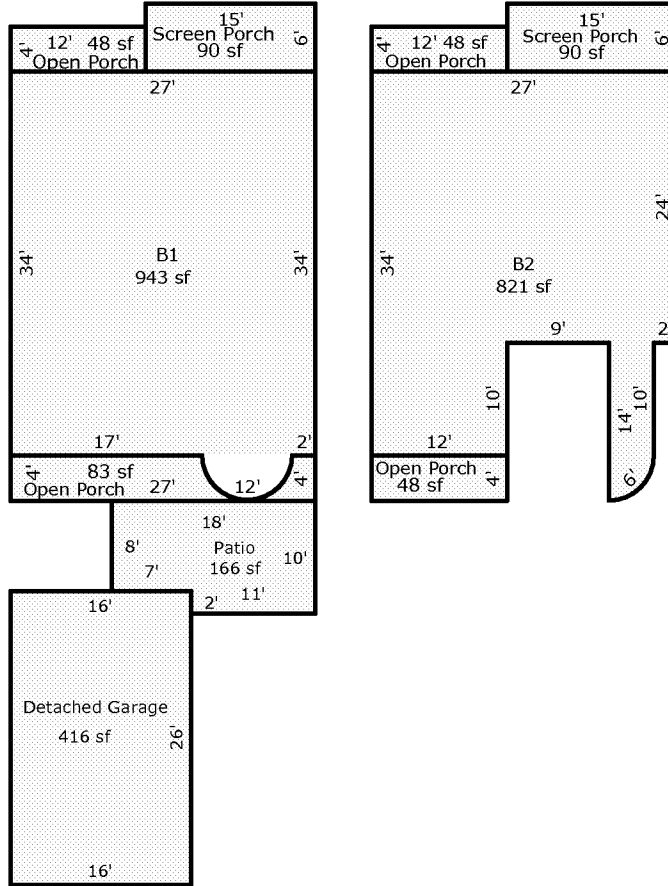

Scale: 1 = 17

AREA CALCULATIONS

AREA CALCULATIONS SUMMARY

Code	Description	Factor	Net Size	Perimeter	Net Totals
B1	B1	1.00	943	126	943
B2	B2	1.00	821	148	821
OP	Open Porch	1.00	83	66	
	Open Porch	1.00	48	32	
	Open Porch	1.00	48	32	
	Open Porch	1.00	48	32	227
PT	Patio	1.00	166	56	166
SP	Screen Porch	1.00	90	42	
	Screen Porch	1.00	90	42	180
GRGD	Detached Garage	1.00	416	84	416

Comment Table 1	
Comment Table 2	Comment Table 3

SKETCH/AREA TABLE ADDENDUM

DATE 10/20/10

RE # 2958781

SUBJECT

PARCEL ID 29-38-36-26*-3
CITY Melbourne Beach COUNTY Brevard STATE FL ZIP 32951
PERMIT # R
MARKET AREA 20 ADDRESS 384 Aquarina Blvd
APPRAISER NAME GAC BRANCH OFFICE PALM BAY

IMPROVEMENTS SKETCH



Scale: 1 = 17

AREA CALCULATIONS

AREA CALCULATIONS SUMMARY					
Code	Description	Factor	Net Size	Perimeter	Net Totals

Comment Table 1	
Comment Table 2	Comment Table 3