

SKETCH/AREA TABLE ADDENDUM

Parcel No 1/6/09

File No 2950845

Property Address 29-37-33-GT-1142-4

City PALM BAY

County BREVARD

State FL

Zip 32909

Owner NONE

Client 141001

Client Address 2198 COGAN DR SE

Appraiser Name LPH

Inspection Date PALM BAY

SUBJECT

IMPROVEMENTS SKETCH

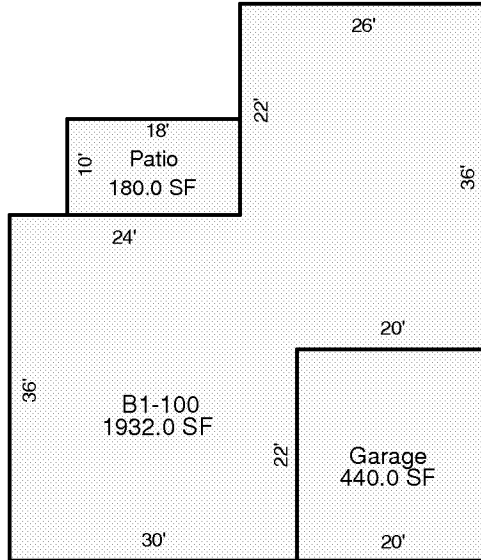

Scale: 1 = 20

AREA CALCULATIONS

AREA CALCULATIONS SUMMARY

Code	Description	Factor	Net Size	Perimeter	Net Totals
B1	B1-100	1.00	1932.0	216.0	1932.0
GA	Garage	1.00	440.0	84.0	440.0
PT	Patio	1.00	180.0	56.0	180.0
