

SKETCH/AREA TABLE ADDENDUM

Parcel No 1/12/07

File No 2950687

Property Address 29-37-33-GT-1134-21

City PALM BAY

County BREVARD

State FL

Zip 32909

Owner 05016362

Client

Client Address 2090 COGAN DR SE

Appraiser Name EWI

Inspection Date PALM BAY

SUBJECT

IMPROVEMENTS SKETCH

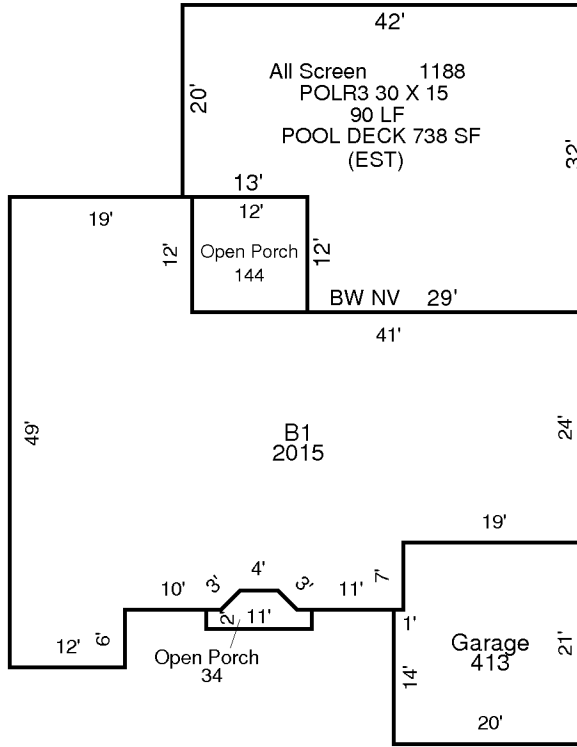

AREA CALCULATIONS

AREA CALCULATIONS SUMMARY

Code	Description	Factor	Net Size	Perimeter	Net Totals
B1	B1	1.00	2015	220	2015
GA	Garage	1.00	413	82	413
OP	Open Porch	1.00	34	28	
	Open Porch	1.00	144	48	178
ALSCN	All Screen	1.00	1188	148	1188
