

SKETCH/AREA TABLE ADDENDUM

File No 2950414

Property Address 29-37-33-GT-1124-22

City PALM BAY

County BREVARD

State FL

Zip 32909

Owner PB5014600

Client

Client Address 1211 TORRINGTON ST SE

Appraiser Name EWI

Inspection Date PALM BAY

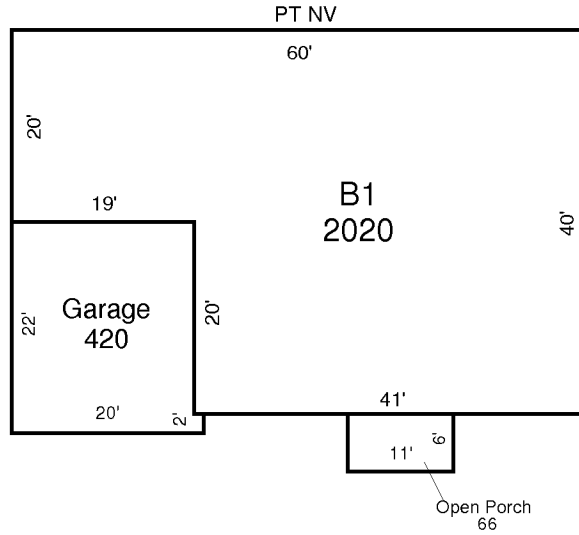

AREA CALCULATIONS SUMMARY

Code	Description	Factor	Net Size	Perimeter	Net Totals
B1	B1	1.00	2020	200	2020
GA	Garage	1.00	420	84	420
OP	Open Porch	1.00	66	34	66