

SKETCH/AREA TABLE ADDENDUM

Parcel No 1/30/07

File No 2949419

Property Address 29-37-32-GU-1194-5

City PALM BAY

County BREVARD

State FL

Zip 32909

Owner PB6000268

Client

Client Address 3124 WEYBURN AVE SE

Appraiser Name EWJ

Inspection Date PALM BAY

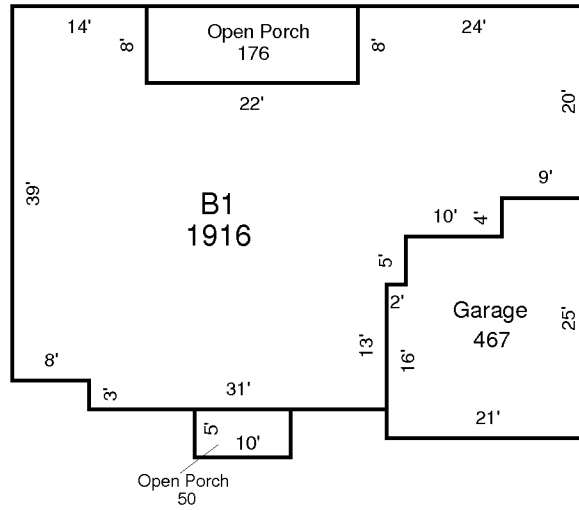

AREA CALCULATIONS SUMMARY

Code	Description	Factor	Net Size	Perimeter	Net Totals
B1	B1	1.00	1916	220	1916
GA	Garage	1.00	467	92	467
OP	Open Porch	1.00	176	60	
	Open Porch	1.00	50	30	226

Comment Table 1

--

Comment Table 2

--

Comment Table 3

--