

SKETCH/AREA TABLE ADDENDUM

File No 2948708

SUBJECT

Property Address 29-37-32-GT-1121-23

City PALM BAY

County Brevard

State FL

Zip 32909

Owner PB5014131

Client Client Address 1133 TORRINGTON ST SE

Appraiser Name EWJ Inspection Date PALM BAY

IMPROVEMENTS SKETCH

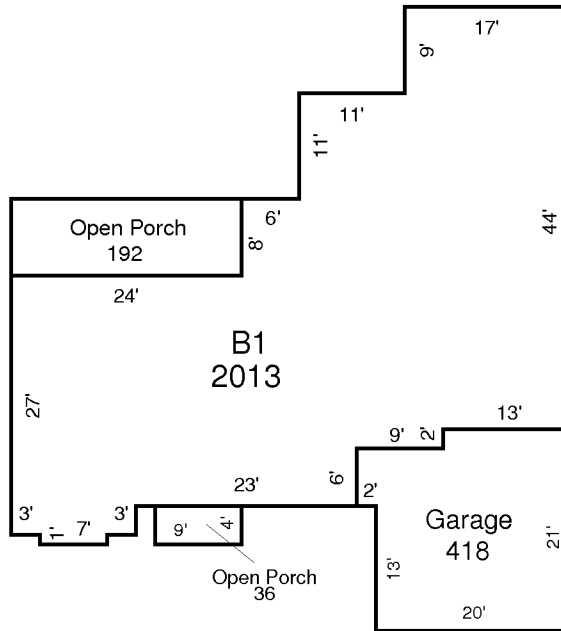

AREA CALCULATIONS

AREA CALCULATIONS SUMMARY

Code	Description	Factor	Net Size	Perimeter	Net Totals
B1	B1	1.00	2013	228	2013
GA	Garage	1.00	418	86	418
OP	Open Porch	1.00	36	26	
	Open Porch	1.00	192	64	228

Comment Table 1

--	--

Comment Table 2

Comment Table 3

--	--