

SKETCH/AREA TABLE ADDENDUM

DATE 2/25/11

RE # 2947921

SUBJECT

PARCEL ID 29-37-31-GV-1307-6

CITY PALMBAY

COUNTY BREVARD

STATE FL

ZIP 32909

PERMIT # R

MARKET AREA 14

ADDRESS 2961 GAFFNEY AV SE

APPRAISER NAME GAC

BRANCH OFFICE PALM BAY

*NO ON SITE MEASUREMENTS CHECKED. PICTOMETRY EST

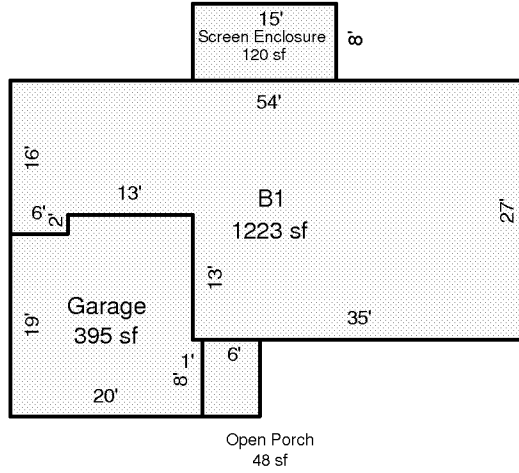

IMPROVEMENTS SKETCH

Scale: 1 = 20

AREA CALCULATIONS

AREA CALCULATIONS SUMMARY

Code	Description	Factor	Net Size	Perimeter	Net Totals
B1	B1	1.00	1223	166	1223
GA	Garage	1.00	395	82	395
OP	Open Porch	1.00	48	28	48
SCREEN	Screen Enclosure	1.00	120	46	120
