

SKETCH/AREA TABLE ADDENDUM

DATE 7/19/10

RE # 2947390

SUBJECT

PARCEL ID 29-37-31-GV-1287-27			
CITY PALM BAY	COUNTY BREVARD	STATE FL	ZIP 32909
PERMIT # PB5014497			
MARKET AREA 14		ADDRESS 599 JEWELL ST SE	
APPRAISER NAME EWI		BRANCH OFFICE PALM BAY	

IMPROVEMENTS SKETCH

EST FROM PICTOMETRY

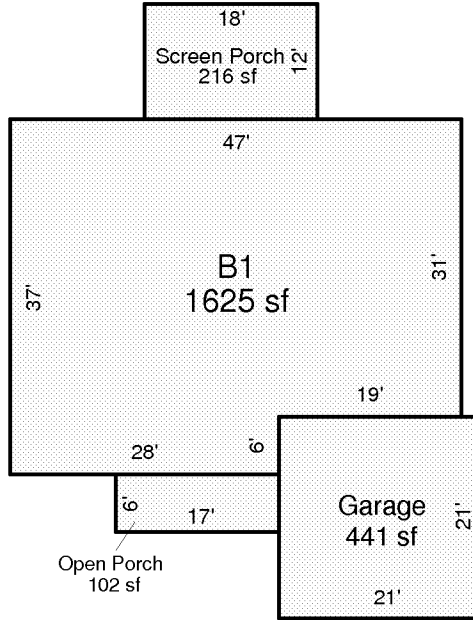

Scale: 1 = 20

AREA CALCULATIONS

AREA CALCULATIONS SUMMARY

Code	Description	Factor	Net Size	Perimeter	Net Totals
B1	B1	1.00	1625	168	1625
GA	Garage	1.00	441	84	441
OP	Open Porch	1.00	102	46	102
SP	Screen Porch	1.00	216	60	216

Comment Table 1

--	--

Comment Table 2

Comment Table 3

--	--