

# SKETCH/AREA TABLE ADDENDUM

NAME 9/14/07

RE # 2947364

SUBJECT

PARCEL ID	29-37-31-GV-1287-1		
CITY	PALM BAY	COUNTY	BREVARD
		STATE	FL
		ZIP	32909
PERMIT #	PB6006595		
MARKET AREA	14	ADDRESS	598 POPLAR ST SE
APPRAISER NAME	EWI	BRANCH OFFICE	PALM BAY

IMPROVEMENTS SKETCH

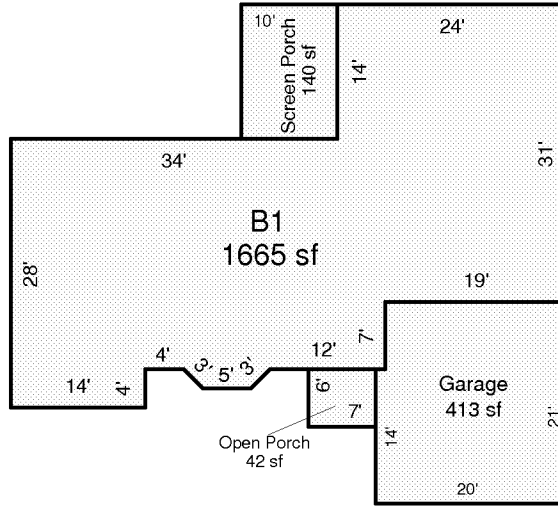

AREA CALCULATIONS

### AREA CALCULATIONS SUMMARY

Code	Description	Factor	Net Size	Perimeter	Net Totals
B1	B1	1.00	1665	202	1665
GA	Garage	1.00	413	82	413
OP	Open Porch	1.00	42	26	42
SP	Screen Porch	1.00	140	48	140

#### Comment Table 1

Comment Table 1	
-----------------	--

#### Comment Table 2

#### Comment Table 3

Comment Table 2	Comment Table 3
-----------------	-----------------