

SKETCH/AREA TABLE ADDENDUM

DATE 2/28/11

RE # 2947362

SUBJECT

PARCEL ID 29 3731GV 1286. 26.			
CITY PALM BAY	COUNTY BREVARD	STATE FL	ZIP 32909
PERMIT # NA			
MARKET AREA 14	ADDRESS 591 SE POPLAR ST		
APPRAISER NAME EWI	BRANCH OFFICE PALM BAY		

IMPROVEMENTS SKETCH

EST FROM PICTOMETRY

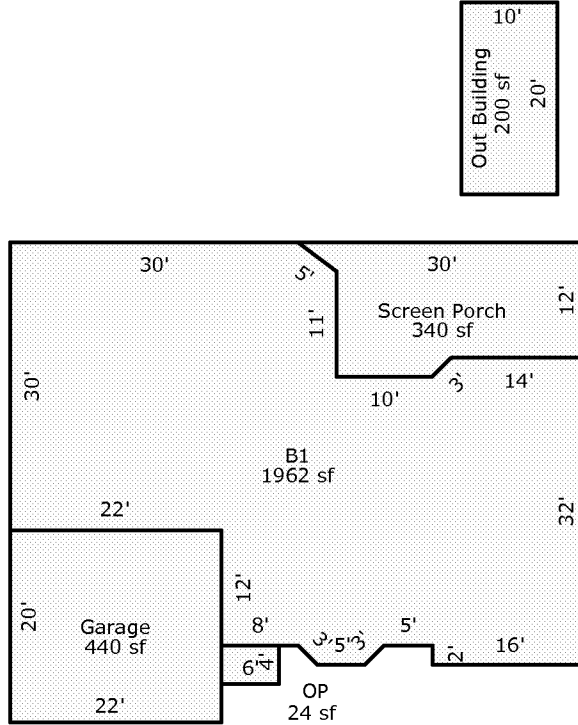

Scale: 1 = 20

AREA CALCULATIONS

AREA CALCULATIONS SUMMARY

Code	Description	Factor	Net Size	Perimeter	Net Totals
B1	B1	1.00	1962	210	1962
GA	Garage	1.00	440	84	440
OP	OP	1.00	24	20	24
SP	Screen Porch	1.00	340	85	340
OBLD	Out Building	1.00	200	60	200

Comment Table 1

--	--

Comment Table 2

Comment Table 3

--	--