

SKETCH/AREA TABLE ADDENDUM

DATE 3/2/11

RE # 2947357

SUBJECT

PARCEL ID	29-37-31-GV-1286-21		
CITY	PALM BAY	COUNTY	BREVARD
		STATE	FL
		ZIP	32909
PERMIT #	PB6005175		
MARKET AREA	14	ADDRESS	551 POPLAR ST SE
APPRAISER NAME	EWI	BRANCH OFFICE	PALM BAY

IMPROVEMENTS SKETCH

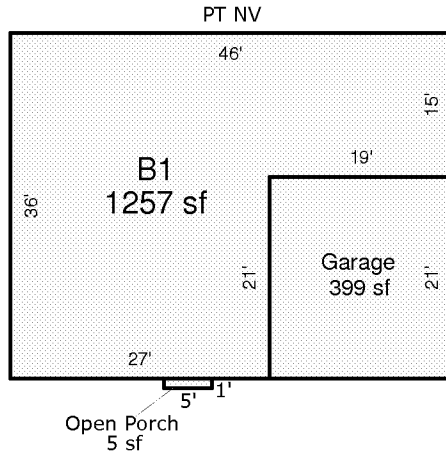

Scale: 1 = 20

AREA CALCULATIONS

AREA CALCULATIONS SUMMARY

Code	Description	Factor	Net Size	Perimeter	Net Totals
B1	B1	1.00	1257	164	1257
GA	Garage	1.00	399	80	399
OP	Open Porch	1.00	5	12	5

Comment Table 1

--

Comment Table 2

Comment Table 3

--	--