

# SKETCH/AREA TABLE ADDENDUM

Parcel No 7/25/08

File No 2947355

Property Address 29-37-31-GV-1286-19

City PALM BAY

County BREVARD

State FL

Zip 32909

Owner NA

Client 14

Client Address 535 POPLAR ST SE

Appraiser Name THL

Inspection Date VIERA

ABV GRD POOL NV

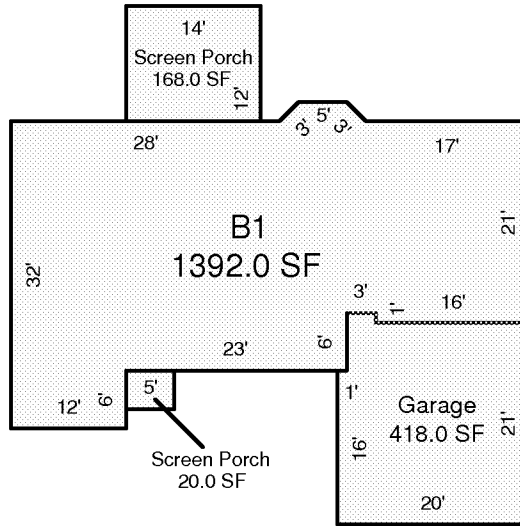

Scale: 1 = 20

## AREA CALCULATIONS SUMMARY

Code	Description	Factor	Net Size	Perimeter	Net Totals
B1	B1	1.00	1392.0	175.7	1392.0
GA	Garage	1.00	418.0	84.0	418.0
SP	Screen Porch	1.00	20.0	18.0	
	Screen Porch	1.00	168.0	52.0	188.0

### Comment Table 1

### Comment Table 2

### Comment Table 3

AREA CALCULATIONS

SUBJECT