

SKETCH/AREA TABLE ADDENDUM

DATE 3/15/11

RE # 2944892

SUBJECT

PARCEL ID 29-37-29-GS-898-13			
CITY PALM BAY	COUNTY BREVARD	STATE FL	ZIP 32909
PERMIT # N			
MARKET AREA 14	ADDRESS 2675 SE QUINCY AVE		
APPRAISER NAME PHK	BRANCH OFFICE PALM BAY		

IMPROVEMENTS SKETCH

NO F/C ALL ESTIMATED W/PICTOMETRY

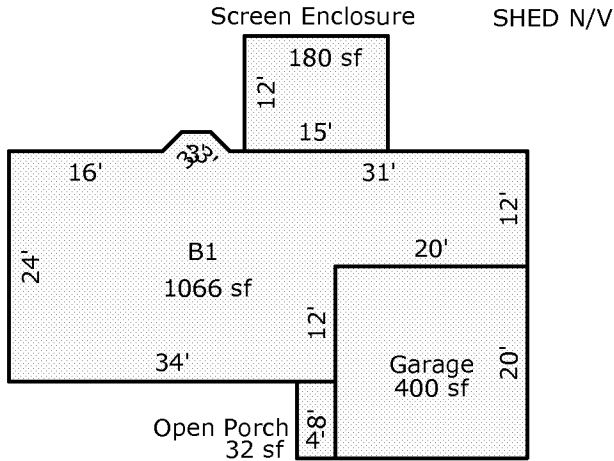

Scale: 1 = 20

AREA CALCULATIONS

AREA CALCULATIONS SUMMARY

Code	Description	Factor	Net Size	Perimeter	Net Totals
B1	B1	1.00	1066	158	1066
GA	Garage	1.00	400	80	400
OP	Open Porch	1.00	32	24	32
SCREN	Screen Enclosure	1.00	180	54	180

Comment Table 1

--

Comment Table 2

Comment Table 3

--	--