

SKETCH/AREA TABLE ADDENDUM

DATE 7/19/10

RE # 2944063

SUBJECT

PARCEL ID 29-37-28-KQ-2038-22A			
CITY PALM BAY	COUNTY BREVARD	STATE FL	ZIP 32909
PERMIT # 05015661			
MARKET AREA 14		ADDRESS 3061 ELDRON BLVD SE	
APPRAISER NAME JEC		BRANCH OFFICE PALM BAY	

3/10/2006

IMPROVEMENTS SKETCH

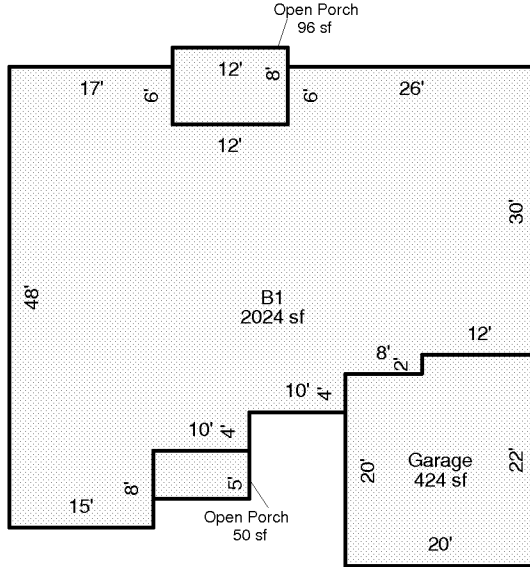

Scale: 1 = 20

AREA CALCULATIONS

AREA CALCULATIONS SUMMARY

Code	Description	Factor	Net Size	Perimeter	Net Totals
B1	B1	1.00	2024	218	2024
GA	Garage	1.00	424	84	424
OP	Open Porch	1.00	50	30	
	Open Porch	1.00	96	40	146

Comment Table 1

--	--

Comment Table 2

Comment Table 3

--	--