

SKETCH/AREA TABLE ADDENDUM

DATE 7/19/10

RE # 2944062

SUBJECT

| | | | |
|--------------------------------|----------------|-----------------------------|-----------|
| PARCEL ID 29-37-28-KQ-2038-21A | | | |
| CITY PALM BAY | COUNTY BREVARD | STATE FL | ZIP 32909 |
| PERMIT # 05014730 | | | |
| MARKET AREA 14 | | ADDRESS 3081 ELDRON BLVD SE | |
| APPRAISER NAME JEC | | BRANCH OFFICE PALM BAY | |

IMPROVEMENTS SKETCH

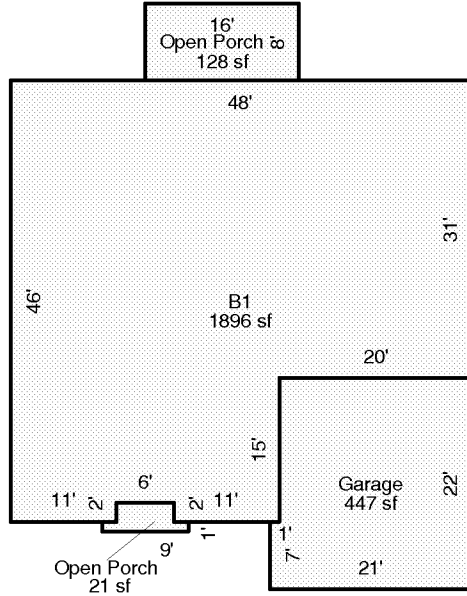

Scale: 1 = 20

AREA CALCULATIONS

AREA CALCULATIONS SUMMARY

| Code | Description | Factor | Net Size | Perimeter | Net Totals |
|------|-------------|--------|----------|-----------|------------|
| B1 | B1 | 1.00 | 1896 | 192 | 1896 |
| GA | Garage | 1.00 | 447 | 86 | 447 |
| OP | Open Porch | 1.00 | 21 | 24 | |
| | Open Porch | 1.00 | 128 | 48 | 149 |

Comment Table 1

| |
|--|
| |
|--|

Comment Table 2

Comment Table 3

| | |
|--|--|
| | |
|--|--|