

SKETCH/AREA TABLE ADDENDUM

File No 2944055

Property Address 29-37-28-KQ-2038-27

City PALMBAY

County BREVARD

State FL

Zip

Owner PB0102932

Client

Client Address 3011 ELDRON BLVD SE

Appraiser Name JOHN T

Inspection Date VIERA

6/12/2001

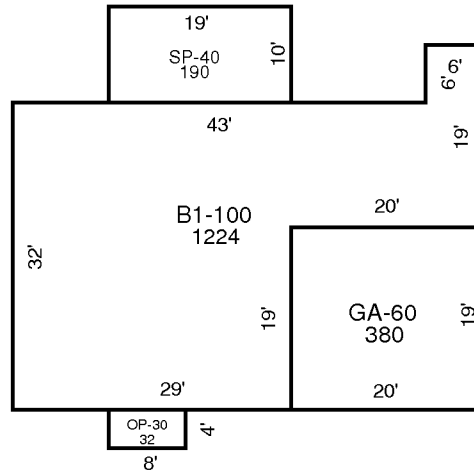

AREA CALCULATIONS SUMMARY

Code	Description	Factor	Net Size	Perimeter	Net Totals
B1	B1-100	1.00	1224	174	1224
GA7	GA-60	1.00	380	78	380
OP4	OP-30	1.00	32	24	32
SP4	SP-40	1.00	190	58	190