

SKETCH/AREA TABLE ADDENDUM

DATE 3/14/11

RE # 2939866

SUBJECT

PARCEL ID 29-37-21-GR-941-20

CITY PALM BAY

COUNTY BREVARD

STATE FL

ZIP 32909

PERMIT # N

MARKET AREA 14

ADDRESS 1631 SE WAINWRIGHT ST

APPRAISER NAME PHK

BRANCH OFFICE PALM BAY

IMPROVEMENTS SKETCH

Out Building

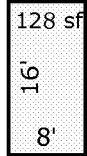

NO F/C ALL ESTIMATED W/PICTOMETRY

CAR PORT N/V

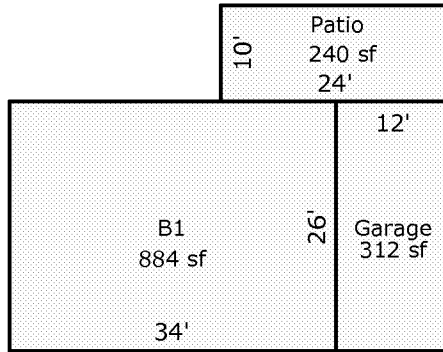

OP N/V

Scale: 1 = 20

AREA CALCULATIONS

AREA CALCULATIONS SUMMARY

| Code | Description | Factor | Net Size | Perimeter | Net Totals |
|------|--------------|--------|----------|-----------|------------|
| B1 | B1 | 1.00 | 884 | 120 | 884 |
| GA | Garage | 1.00 | 312 | 76 | 312 |
| PT | Patio | 1.00 | 240 | 68 | 240 |
| OBLD | Out Building | 1.00 | 128 | 48 | 128 |

Comment Table 1

| | |
|-----------------|--|
| Comment Table 1 | |
|-----------------|--|

Comment Table 2

Comment Table 3

| | |
|-----------------|-----------------|
| Comment Table 2 | Comment Table 3 |
|-----------------|-----------------|