

# SKETCH/AREA TABLE ADDENDUM

NAME 8/10/07

RE # 2938880

SUBJECT

PARCEL ID	29-37-20-GQ-851-20		
CITY	PALM BAY	COUNTY	BREVARD
		STATE	FL
PERMIT #	NONE		
MARKET AREA	14	ADDRESS	1050 WYOMING DR. SE
APPRAISER NAME	EWI	BRANCH OFFICE	PALM BAY

IMPROVEMENTS SKETCH

ABOVE GROUND POOL NV

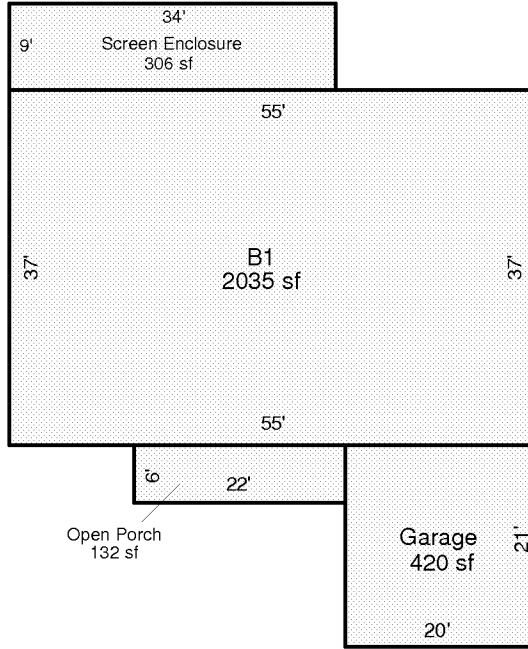

AREA CALCULATIONS

### AREA CALCULATIONS SUMMARY

Code	Description	Factor	Net Size	Perimeter	Net Totals
B1	B1	1.00	2035	184	2035
GA	Garage	1.00	420	82	420
OP	Open Porch	1.00	132	56	132
SCREEN	Screen Enclosure	1.00	306	86	306