

# SKETCH/AREA TABLE ADDENDUM

DATE 7/13/10

RE # 2938614

SUBJECT

PARCEL ID 29-37-20-GQ-826-11			
CITY PALM BAY	COUNTY BREVARD	STATE FL	ZIP 32909
PERMIT # PB4014230			
MARKET AREA 14		ADDRESS 1999 RADCLIFF AVE SE	
APPRAISER NAME EWI		BRANCH OFFICE PALM BAY	

IMPROVEMENTS SKETCH

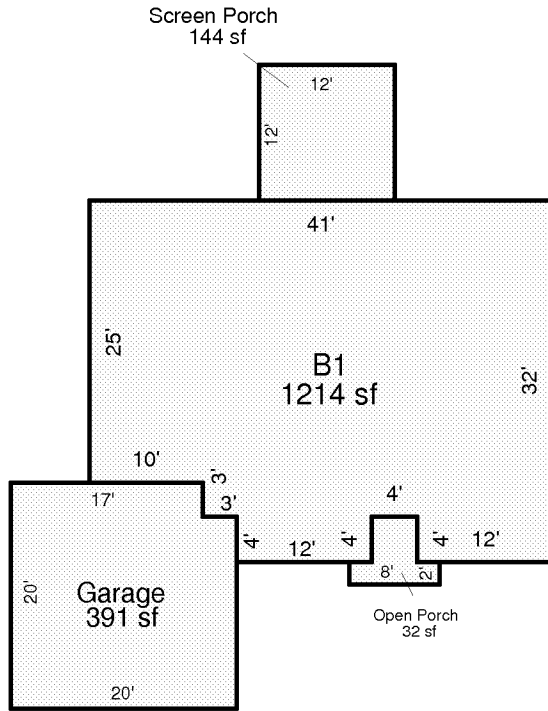

Scale: 1 = 17

AREA CALCULATIONS

### AREA CALCULATIONS SUMMARY

Code	Description	Factor	Net Size	Perimeter	Net Totals
B1	B1	1.00	1214	154	1214
GA	Garage	1.00	391	80	391
OP	Open Porch	1.00	32	28	32
SP	Screen Porch	1.00	144	48	144

#### Comment Table 1

--

#### Comment Table 2

#### Comment Table 3

--	--