

# SKETCH/AREA TABLE ADDENDUM

Parcel No 1/31/07

File No 2937736

Property Address 29-37-18-JR-2676-23

City PALM BAY

County BREVARD

State FL

Zip 32909

Owner PB5016887

Client

Client Address 355 SAUDERS RD SE

Appraiser Name EWI

Inspection Date PALM BAY

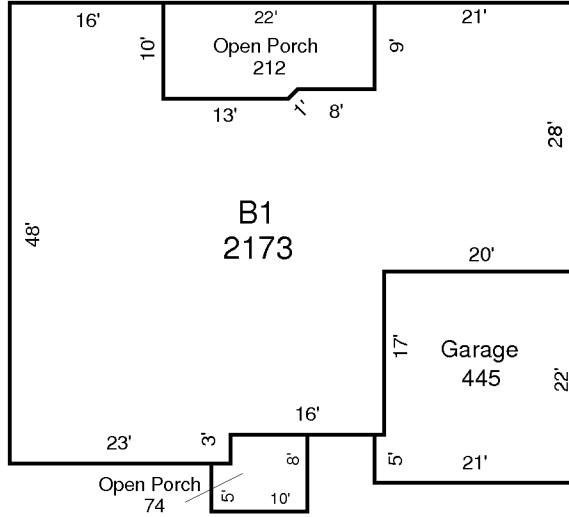

## AREA CALCULATIONS SUMMARY

Code	Description	Factor	Net Size	Perimeter	Net Totals
B1	B1	1.00	2173	233	2173
GA	Garage	1.00	445	86	445
OP	Open Porch	1.00	74	36	
	Open Porch	1.00	212	63	285