

SKETCH/AREA TABLE ADDENDUM

Date 8/14/09

RE # 2936738

SUBJECT

| | | | |
|----------------|----------------|---------------|----------------------|
| Parcel ID | 29-37-18-JR-K- | | |
| City | PALM BAY | County | Brevard |
| | | State | FL |
| Permit # | NONE | | |
| Market Area | 14 | Address | 1601 ANTIQUE TERR SE |
| Appraiser Name | LPH | Branch Office | PALM BAY |

IMPROVEMENTS SKETCH

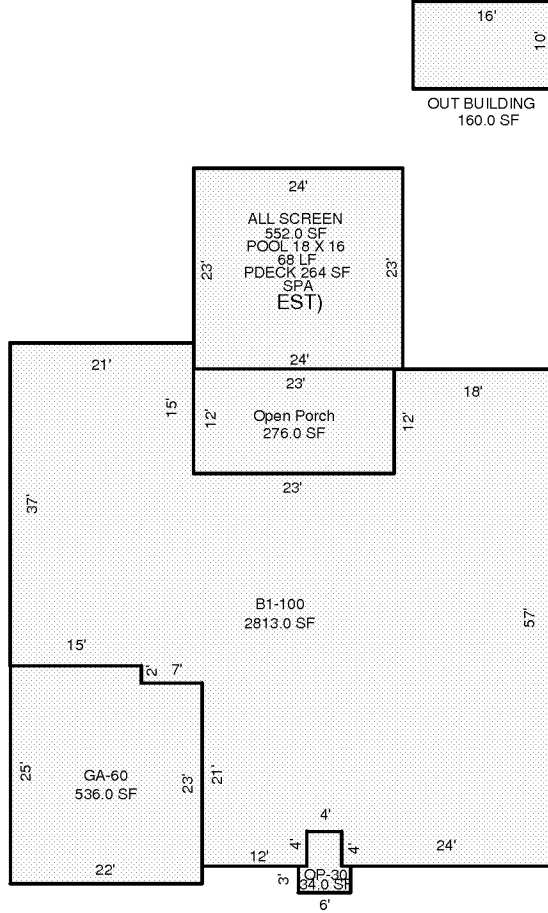

Scale: 1 = 22

AREA CALCULATIONS

AREA CALCULATIONS SUMMARY

| Code | Description | Factor | Net Size | Perimeter | Net Totals |
|-------|--------------|--------|----------|-----------|------------|
| B1 | B1-100 | 1.00 | 2813.0 | 276.0 | 2813.0 |
| OP | Open Porch | 1.00 | 276.0 | 70.0 | 276.0 |
| ALSCN | ALL SCREEN | 1.00 | 552.0 | 94.0 | 552.0 |
| GA7 | GA-60 | 1.00 | 536.0 | 94.0 | 536.0 |
| OP4 | OP-30 | 1.00 | 34.0 | 26.0 | 34.0 |
| OBLDG | OUT BUILDING | 1.00 | 160.0 | 52.0 | 160.0 |

Comment Table 1

| |
|--|
| |
|--|

Comment Table 2

Comment Table 3

| | |
|--|--|
| | |
|--|--|