

SKETCH/AREA TABLE ADDENDUM

File No 2936703

Property Address 29-37-17-JR-2745-18

City PALM BAY

County BREVARD

State FL

Zip 32909

Owner

Client Client Address 639 RALEIGH RD SE

Appraiser Name EWI

Inspection Date PALM BAY

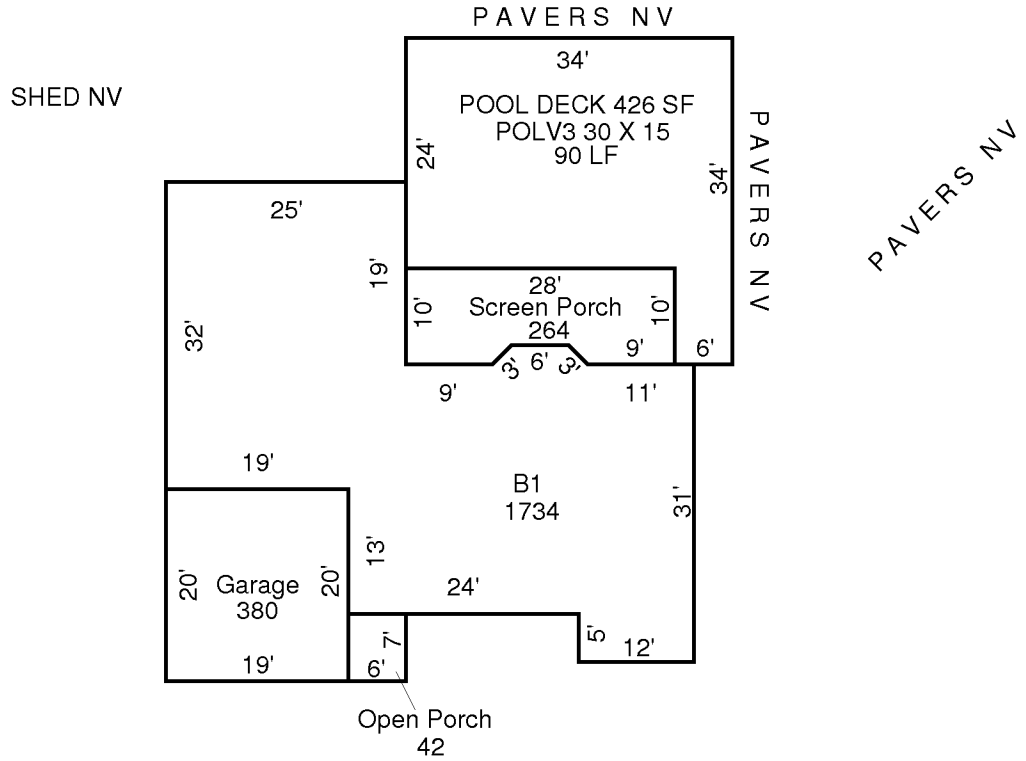

AREA CALCULATIONS SUMMARY

Code	Description	Factor	Net Size	Perimeter	Net Totals
B1	B1	1.00	1734	212	1734
GA	Garage	1.00	380	78	380
OP	Open Porch	1.00	42	26	42
SP	Screen Porch	1.00	264	78	264
PDECK	Pool Deck	1.00	876	136	876

Comment Table 1

Comment Table 2

Comment Table 3