

# SKETCH/AREA TABLE ADDENDUM

Parcel No 12/20/06

File No 2936389

Property Address 29-37-17-JR-2714-14

City PALM BAY

County BREVARD

State FL

Zip 32909

Owner

Client

Client Address 721 SEVEN GABLES CIR SE

Appraiser Name EWJ

Inspection Date PALM BAY

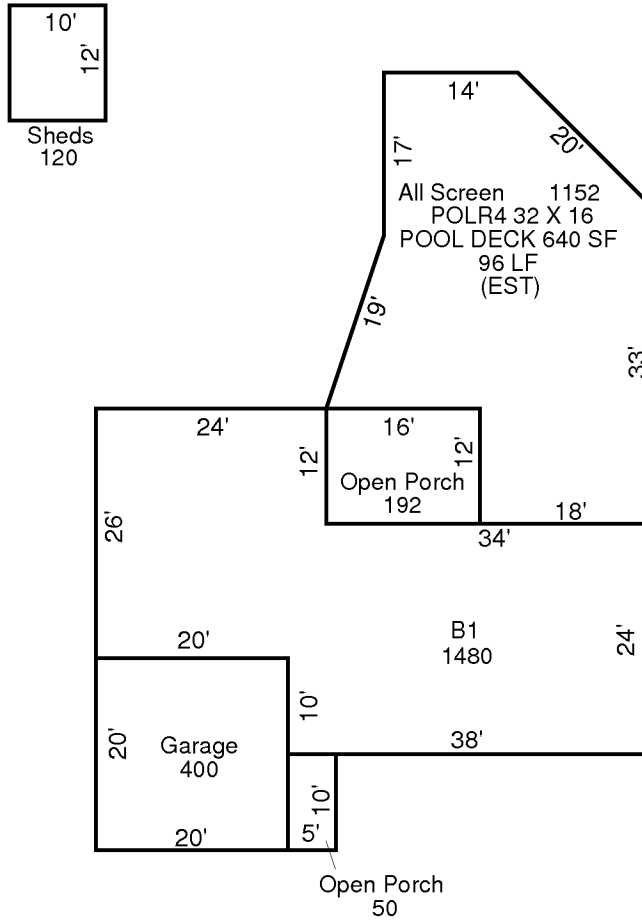

## AREA CALCULATIONS SUMMARY

| Code  | Description | Factor | Net Size | Perimeter | Net Totals |
|-------|-------------|--------|----------|-----------|------------|
| B1    | B1          | 1.00   | 1480     | 188       | 1480       |
| GA    | Garage      | 1.00   | 400      | 80        | 400        |
| OP    | Open Porch  | 1.00   | 192      | 56        |            |
|       | Open Porch  | 1.00   | 50       | 30        | 242        |
| ALSCN | All Screen  | 1.00   | 1152     | 149       | 1152       |
| SHED  | Sheds       | 1.00   | 120      | 44        | 120        |

### Comment Table 1

### Comment Table 2

### Comment Table 3