

SKETCH/AREA TABLE ADDENDUM

Parcel No 7/10/08

File No 2932268

Property Address 29-37-13-00-781

City GRANT/VALKARIA County BREVARD State FL Zip 329850

Owner SFR 1-31-01 OCO107478 \$80,000

Client 15 Client Address 3757 HOFBAUER WAY

Appraiser Name JEC Inspection Date PALM BAY

SUBJECT

IMPROVEMENTS SKETCH

RE-DRAWN NO F/C

17'
EST.
Out Building^{12'}
204.0 SF

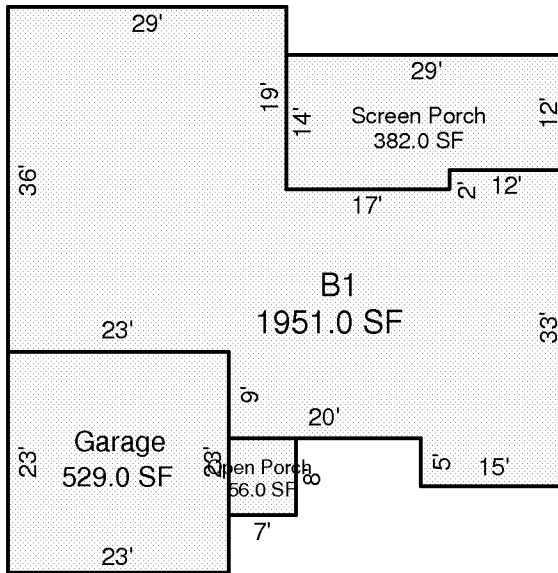

DRAWN: GNL 2-20-01

Scale: 1 = 20

AREA CALCULATIONS

AREA CALCULATIONS SUMMARY

Code	Description	Factor	Net Size	Perimeter	Net Totals
B1	B1	1.00	1951.0	220.0	1951.0
GA	Garage	1.00	529.0	92.0	529.0
OP	Open Porch	1.00	56.0	30.0	56.0
SP	Screen Porch	1.00	382.0	86.0	382.0
OBLD	Out Building	1.00	204.0	58.0	204.0
