

SKETCH/AREA TABLE ADDENDUM

RE # 2930719

SUBJECT	PARCEL ID 29-37-09-GO-401-25			
	CITY PALM BAY	COUNTY BREVARD	STATE FL	ZIP 32909
	PERMIT # NONE			
	MARKET AREA 141	ADDRESS 1309 SAGBLOOM ST SE		
	APPRAISER NAME LPH	BRANCH OFFICE PALM BAY		

IMPROVEMENTS SKETCH

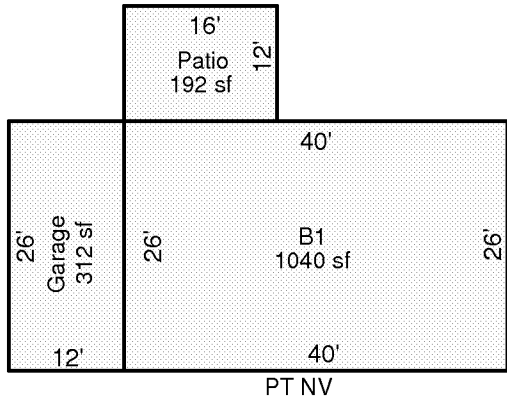

Scale: 1 = 20

AREA CALCULATIONS

AREA CALCULATIONS SUMMARY					
Code	Description	Factor	Net Size	Perimeter	Net Totals
B1	B1	1.00	1040	132	1040
GA	Garage	1.00	312	76	312
PT	Patio	1.00	192	56	192

Comment Table 1	
Comment Table 2	Comment Table 3