

# SKETCH/AREA TABLE ADDENDUM

Parcel No 2/7/07

File No 2928544

Property Address 29-37-08-GL-430-2

City PALM BAY

County BREVARD

State FL

Zip 32909

Owner PB5016578

Client

Client Address 738 DIPLOMAT AVE SE

Appraiser Name EWI

Inspection Date PALM BAY

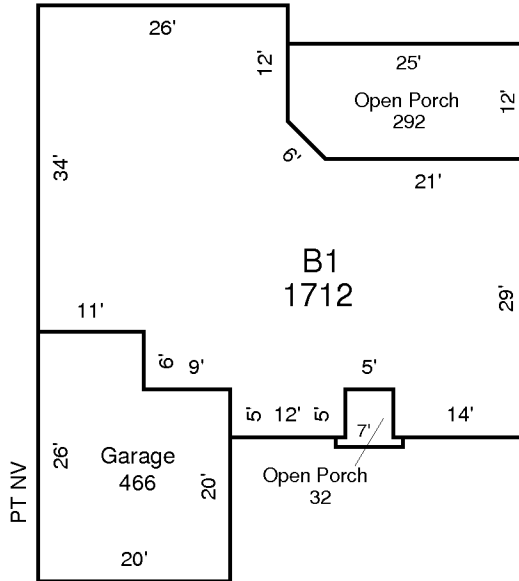

## AREA CALCULATIONS SUMMARY

Code	Description	Factor	Net Size	Perimeter	Net Totals
B1	B1	1.00	1712	200	1712
GA	Garage	1.00	466	92	466
OP	Open Porch	1.00	32	26	
	Open Porch	1.00	292	72	324

### Comment Table 1

### Comment Table 2

### Comment Table 3