

# SKETCH/AREA TABLE ADDENDUM

DATE 7/9/10

RE # 2928358

SUBJECT

PARCEL ID 29-37-08-GL-421-12			
CITY PALM BAY	COUNTY BREVARD	STATE FL	ZIP 32909
PERMIT # 05008668			
MARKET AREA 14		ADDRESS 801 CLIFTON RD SE	
APPRAISER NAME EWI		BRANCH OFFICE PALM BAY	

IMPROVEMENTS SKETCH

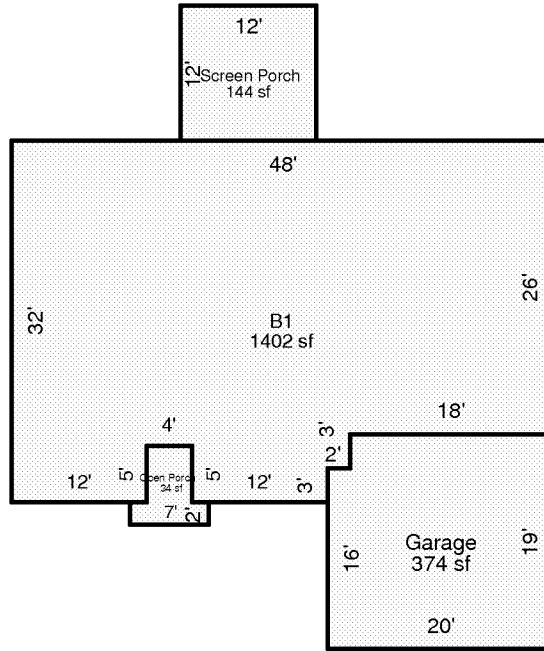

Scale: 1 = 17

AREA CALCULATIONS

### AREA CALCULATIONS SUMMARY

Code	Description	Factor	Net Size	Perimeter	Net Totals
B1	B1	1.00	1402	170	1402
GA	Garage	1.00	374	78	374
OP	Open Porch	1.00	34	28	34
SP	Screen Porch	1.00	144	48	144

#### Comment Table 1

--

#### Comment Table 2

#### Comment Table 3

--	--