

# SKETCH/AREA TABLE ADDENDUM

File No 2927831

Property Address 29-37-07-GN-532-12

City PALM BAY

County Brevard

State FL

Zip 32909

Owner PB5012894

Client

Client Address 512 COLLINGS ST SE

Appraiser Name EWI

Inspection Date PALM BAY

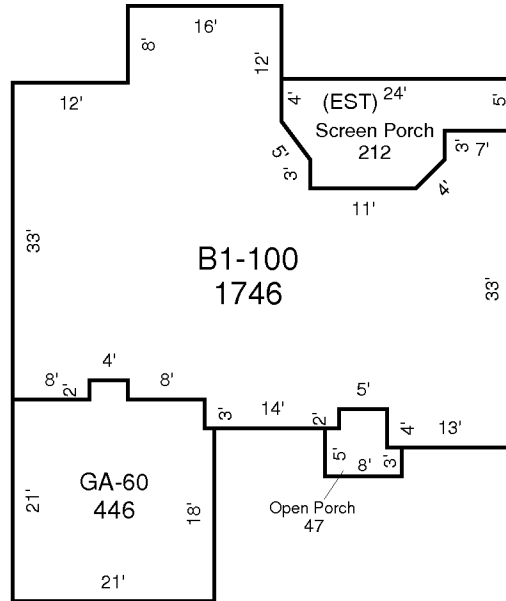

## AREA CALCULATIONS SUMMARY

Code	Description	Factor	Net Size	Perimeter	Net Totals
B1	B1-100	1.00	1746	212	1746
GA7	GA-60	1.00	446	88	446
OP	Open Porch	1.00	47	30	47
SP	Screen Porch	1.00	212	67	212

## Comment Table 1

--	--

## Comment Table 2

--

## Comment Table 3

--