

SKETCH/AREA TABLE ADDENDUM

DATE 6/15/10

RE # 2926803

SUBJECT

PARCEL ID	29-37-07-GN-494-5		
CITY	PALM BAY	COUNTY	Brevard
		STATE	FL
ZIP	32909		
PERMIT #	R		
MARKET AREA	14	ADDRESS	847 BAYHARBOR AV SE
APPRAISER NAME	GAC	BRANCH OFFICE	PALM BAY

*NO ON SITE MEASUREMENTS CHECKED. PICTOMETRY EST

SHED NV

Driveway N/V

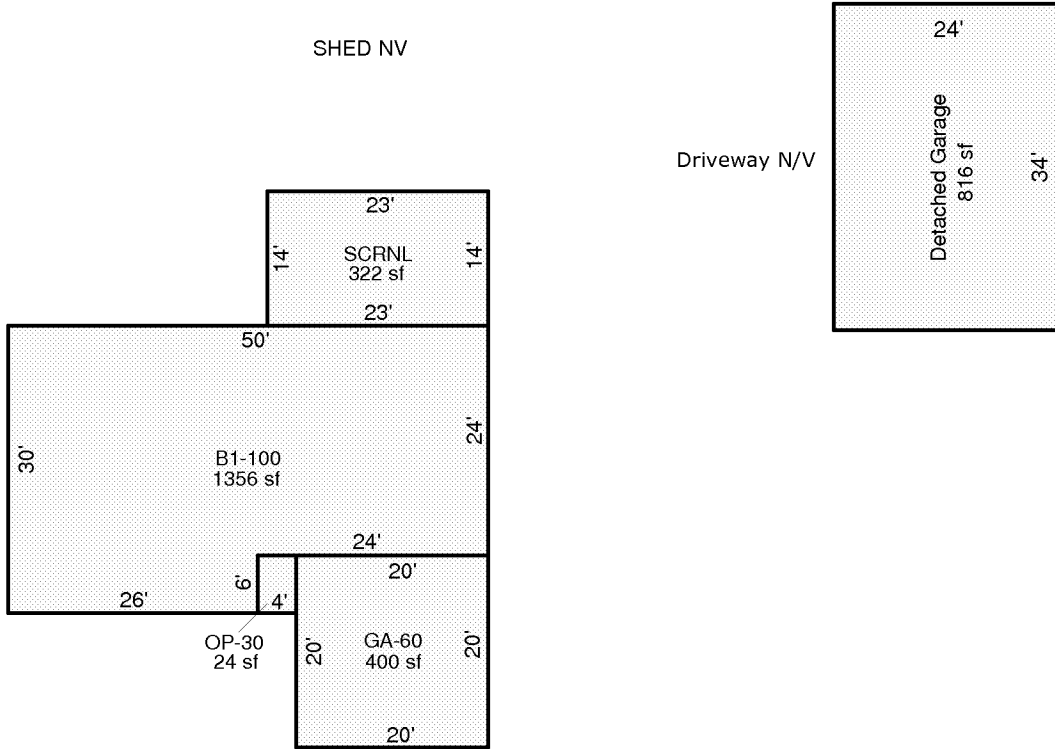

IMPROVEMENTS SKETCH

Scale: 1 = 20

AREA CALCULATIONS

AREA CALCULATIONS SUMMARY

Code	Description	Factor	Net Size	Perimeter	Net Totals
B1	B1-100	1.00	1356	160	1356
GRGD	Detached Garage	1.00	816	116	816
OP4	OP-30	1.00	24	20	24
SP4	SCRNL	1.00	322	74	322
GA7	GA-60	1.00	400	80	400

Comment Table 1

--

Comment Table 2

Comment Table 3

--	--