

SKETCH/AREA TABLE ADDENDUM

Parcel No 6/13/11

File No 2926737

Property Address 29-37-07-GN-491-14

City PALM BAY

County BREVARD

State FL

Zip 32909

Owner N

Client 14

Client Address 323 SE ROYAL ST

Appraiser Name PHK

Inspection Date PALM BAY

NO F/C ALL ESTIMATED W/PICTOMETRY

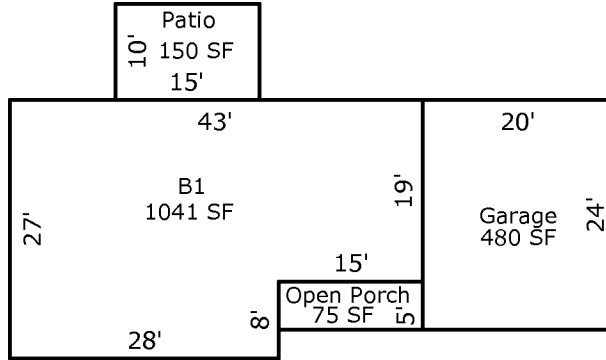

Scale: 1" = 12'

AREA CALCULATIONS SUMMARY

Code	Description	Factor	Net Size	Perimeter	Net Totals
B1	B1	1.00	1041	140	1041
GA	Garage	1.00	480	88	480
OP	Open Porch	1.00	75	40	75
PT	Patio	1.00	150	50	150

Comment Table 1

--	--

Comment Table 2

Comment Table 3

--	--

AREA CALCULATIONS

SUBJECT

IMPROVEMENTS SKETCH