

SKETCH/AREA TABLE ADDENDUM

Parcel No 12/12/06

File No 2926165

Property Address 29-37-06-GK-410-7

City PALM BAY

County BREVARD

State FL

Zip 32909

Owner PB6002637

Client

Client Address 581 ELDRON BLVD SE

Appraiser Name EWJ

Inspection Date PALM BAY

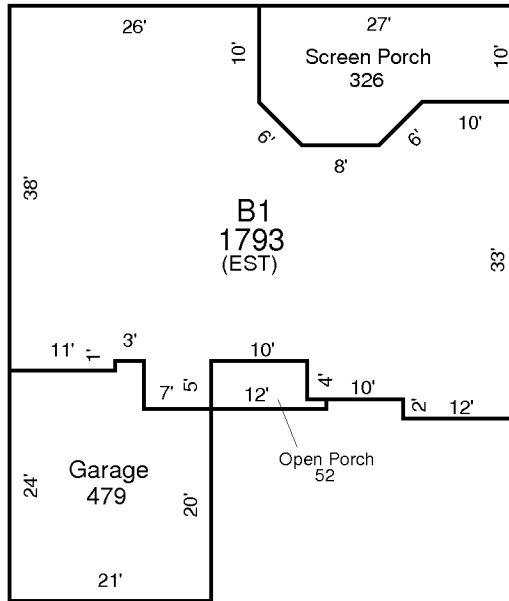

AREA CALCULATIONS SUMMARY

Code	Description	Factor	Net Size	Perimeter	Net Totals
B1	B1	1.00	1793	208	1793
GA	Garage	1.00	479	92	479
OP	Open Porch	1.00	52	34	52
SP	Screen Porch	1.00	326	78	326

Comment Table 1

Comment Table 2

Comment Table 3