

SKETCH/AREA TABLE ADDENDUM

Parcel No 12/12/06

File No 2925864

Property Address 29-37-06-GK-393-1

City PALM BAY

County BREVARD

State FL

Zip 32909

Owner PB5016932

Client

Client Address 410 ELDRON BLVD SE

Appraiser Name EWJ

Inspection Date PALM BAY

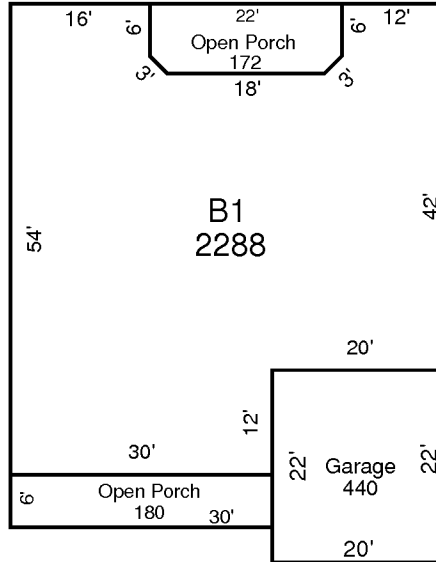

AREA CALCULATIONS SUMMARY

Code	Description	Factor	Net Size	Perimeter	Net Totals
B1	B1	1.00	2288	222	2288
GA	Garage	1.00	440	84	440
OP	Open Porch	1.00	180	72	
	Open Porch	1.00	172	58	352

Comment Table 1

Comment Table 2

Comment Table 3