

SKETCH/AREA TABLE ADDENDUM

RE # 2923859

SUBJECT	PARCEL ID 29-37-05-GJ-315-21	COUNTY BREVARD	STATE FL	ZIP 32909
	CITY PALM BAY			
	PERMIT # PB5014883			
	MARKET AREA	ADDRESS 702 EMPRESS ST SE		
	APPRAISER NAME EWI	BRANCH OFFICE PALM BAY		

EST FROM PICTOMETRY

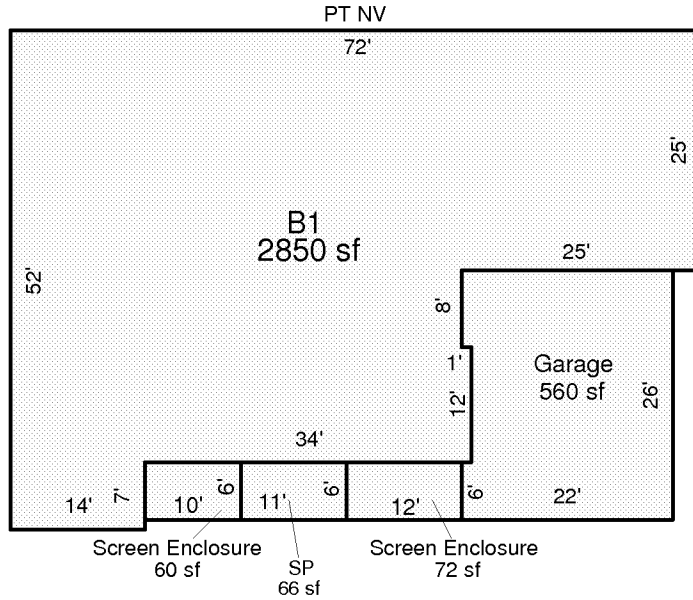

Scale: 1 = 20

AREA CALCULATIONS SUMMARY						Comment Table 1	
Code	Description	Factor	Net Size	Perimeter	Net Totals		
B1	B1	1.00	2850	250	2850		
GA	Garage	1.00	560	98	560		
SP	SP	1.00	66	34	66		
SCREN	Screen Enclosure	1.00	72	36	132		
	Screen Enclosure	1.00	60	32			
						Comment Table 2	Comment Table 3