

SKETCH/AREA TABLE ADDENDUM

DATE 11/08/2006

RE # 2913431

SUBJECT

PARCEL ID 29-36-25-JP-1518-15			
CITY PALM BAY	COUNTY BREVARD	STATE FL	ZIP 32908
PERMIT # PB5010085			
MARKET AREA	ADDRESS 237 GARDNER RD SW		
APPRAISER NAME JEC	BRANCH OFFICE PALM BAY		

IMPROVEMENTS SKETCH

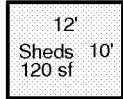

EST FROM PICTOMETRY

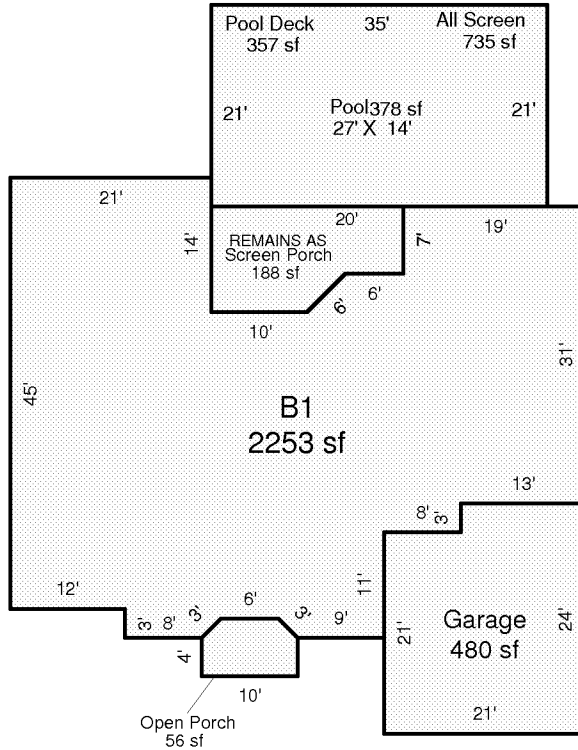

Scale: 1 = 20

AREA CALCULATIONS

AREA CALCULATIONS SUMMARY

Code	Description	Factor	Net Size	Perimeter	Net Totals
B1	B1	1.00	2253	237	2253
GA	Garage	1.00	480	90	480
OP	Open Porch	1.00	56	30	56
SP	Screen Porch	1.00	188	60	188
ALSCN	All Screen	1.00	735	112	735
PDECK	Pool Deck	1.00	357	112	357
POOL	Pool	1.00	378	82	378
SHED	Sheds	1.00	120	44	120

Comment Table 1

--	--

Comment Table 2

Comment Table 3

--	--