

SKETCH/AREA TABLE ADDENDUM

File No 29056060

SUBJECT

Property Address	29-36-12-KH-1669-12		
City	PALM BAY	County	BREVARD
		State	FL
Owner	99-3743		
Client		Client Address	781 GERANIUM AVE
Appraiser Name	JOHN T	Inspection Date	VIERA

IMPROVEMENTS SKETCH

7/22/99

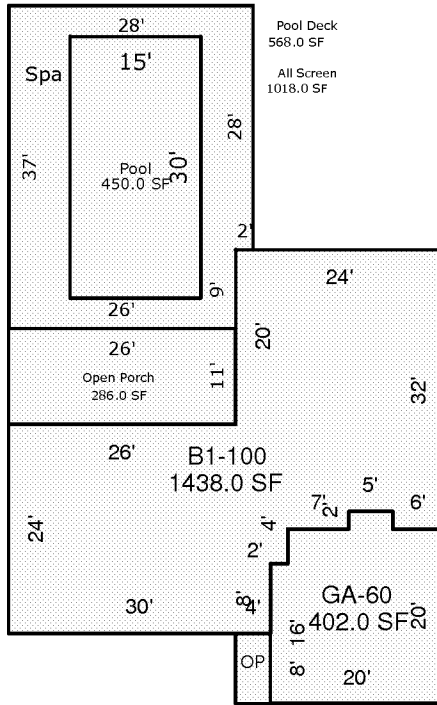

Scale: 1 = 22

AREA CALCULATIONS

AREA CALCULATIONS SUMMARY

Code	Description	Factor	Net Size	Perimeter	Net Totals
B1	B1-100	1.00	1438.0	192.0	1438.0
OP	Open Porch	1.00	286.0	74.0	286.0
ALSCN	All Screen	1.00	1018.0	130.0	1018.0
PDECK	Pool Deck	1.00	568.0	130.0	568.0
POOL	Pool	1.00	450.0	90.0	450.0
GA7	GA-60	1.00	402.0	84.0	402.0
OP4	OP-30	1.00	32.0	24.0	32.0
