

SKETCH/AREA TABLE ADDENDUM

Parcel No 12/10/08

File No 2905607

SUBJECT

Property Address 293612KH1669-13

City PALM BAY

County BREVARD

State FL

Zip 32908

Owner NA

Client 14

Client Address 791 GERANIUM AVE SW

Appraiser Name THL

Inspection Date VIERA

IMPROVEMENTS SKETCH

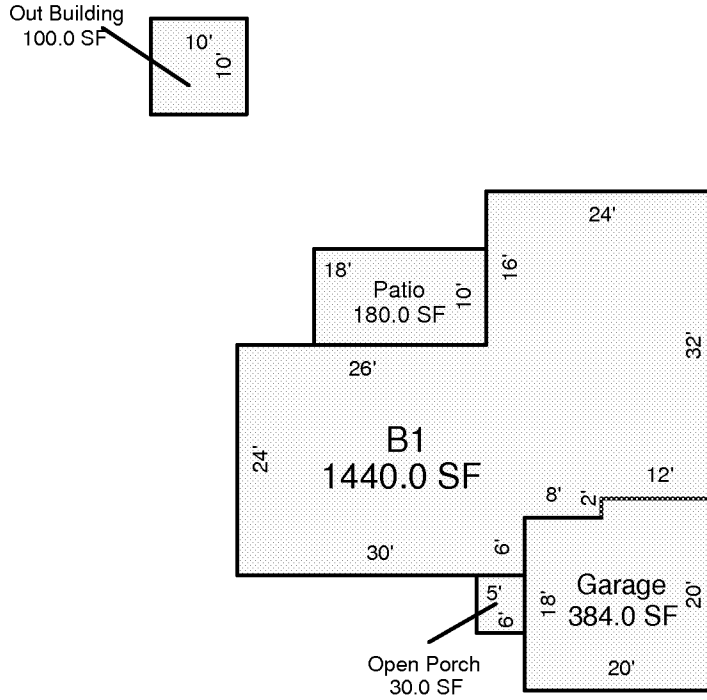

Scale: 1 = 20

AREA CALCULATIONS

AREA CALCULATIONS SUMMARY

Code	Description	Factor	Net Size	Perimeter	Net Totals
B1	B1	1.00	1440.0	180.0	1440.0
GA	Garage	1.00	384.0	80.0	384.0
OP	Open Porch	1.00	30.0	22.0	30.0
PT	Patio	1.00	180.0	56.0	180.0
OBLD	Out Building	1.00	100.0	40.0	100.0

Comment Table 1

--	--

Comment Table 2

Comment Table 3

--	--