

# SKETCH/AREA TABLE ADDENDUM

Parcel No 1/8/07

File No 2905413

Property Address 29-36-12-KH-1662-35

City PALM BAY

County BREVARD

State FL

Zip 32908

Owner

Client Client Address 351 HARRINGTON ST SW

Appraiser Name JEC

Inspection Date PALM BAY

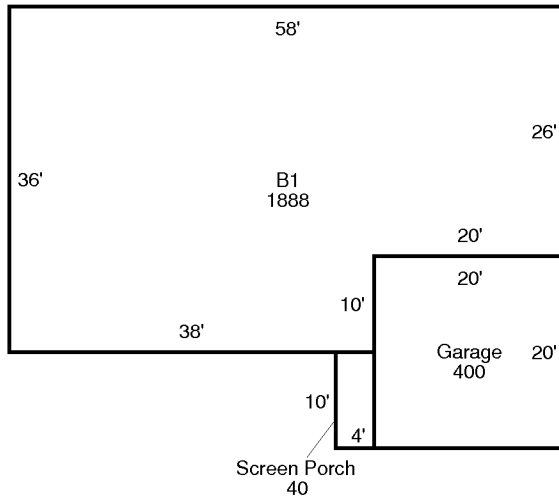

## AREA CALCULATIONS SUMMARY

Code	Description	Factor	Net Size	Perimeter	Net Totals
B1	B1	1.00	1888	188	1888
GA	Garage	1.00	400	80	400
SP	Screen Porch	1.00	40	28	40

### Comment Table 1

--	--

### Comment Table 2

### Comment Table 3

--	--