

# SKETCH/AREA TABLE ADDENDUM

Parcel No 1/3/08

File No 2904845

Property Address 29-36-11-KL-1641-7

City PALM BAY

County BREVARD

State FL

Zip 32907

Owner PB0703371

Client 14

Client Address 746 DALHART AVE SW

Appraiser Name JEC

Inspection Date PALM BAY

SUBJECT

IMPROVEMENTS SKETCH

AREA CALCULATIONS

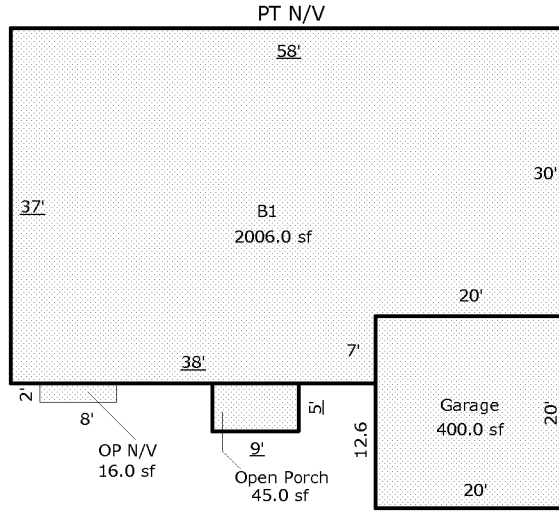

Scale: 1 = 20

### AREA CALCULATIONS SUMMARY

Code	Description	Factor	Net Size	Perimeter	Net Totals
B1	B1	1.00	2006.0	190.0	2006.0
GA	Garage	1.00	400.0	80.0	400.0
OP	Open Porch	1.00	45.0	28.0	45.0
