

# SKETCH/AREA TABLE ADDENDUM

DATE 16 NOV. 2010

RE # 2862776

SUBJECT

PARCEL ID 28 370707 90

CITY WEST MELBOURNE

COUNTY BREVARD

STATE FL

ZIP 32904

PERMIT # 1000000637

MARKET AREA 12

ADDRESS 2184 BOTANICA CIR.

APPRAISER NAME WHS

BRANCH OFFICE TITUSVILLE

IMPROVEMENTS SKETCH

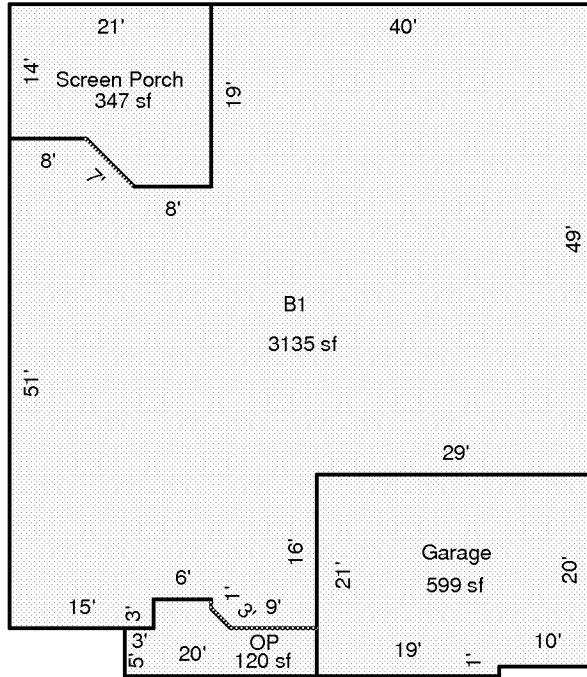

Scale: 1 = 20

AREA CALCULATIONS

### AREA CALCULATIONS SUMMARY

Code	Description	Factor	Net Size	Perimeter	Net Totals
B1	B1	1.00	3135	264	3135
GA	Garage	1.00	599	100	599
OP	OP	1.00	120	55	120
SP	Screen Porch	1.00	347	77	347

#### Comment Table 1

--	--

#### Comment Table 2

#### Comment Table 3

--	--