

SKETCH/AREA TABLE ADDENDUM

DATE 12/11/09

RE # 2862741

SUBJECT

PARCEL ID	28370707-56						
CITY	WEST MELBOURNE	COUNTY	BREVARD	STATE	FL	ZIP	32904
PERMIT #	0700114						
MARKET AREA	12	ADDRESS	1864 BOTANICA CIR				
APPRAISER NAME	PHK	BRANCH OFFICE	PALM BAY				

IMPROVEMENTS SKETCH

NO F/C ALL ESTIMATED W/PICTOMETRY

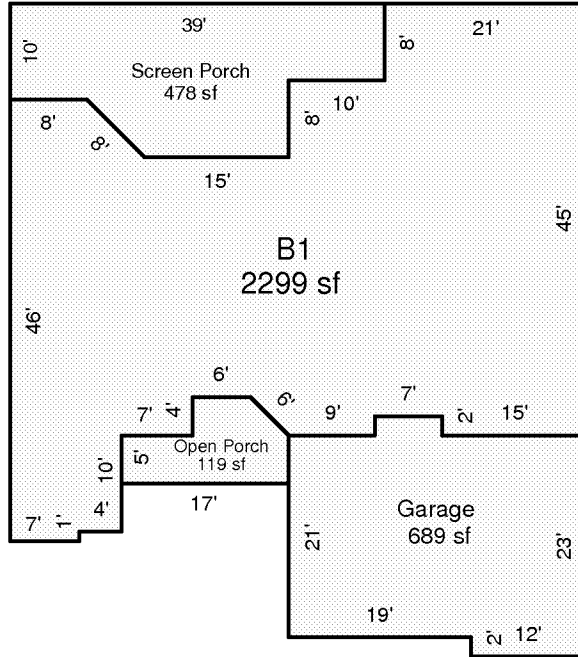

Scale: 1 = 20

AREA CALCULATIONS

AREA CALCULATIONS SUMMARY

Code	Description	Factor	Net Size	Perimeter	Net Totals
B1	B1	1.00	2299	250	2299
GA	Garage	1.00	689	112	689
OP	Open Porch	1.00	119	50	119
SP	Screen Porch	1.00	478	106	478

Comment Table 1

--	--

Comment Table 2

Comment Table 3

--	--