

SKETCH/AREA TABLE ADDENDUM

DATE 1/6/10

RE # 2852777

SUBJECT

PARCEL ID	28 370775 B. 379		
CITY	W. MELBOURNE	COUNTY	BREVARD
		STATE	FL
		ZIP	32904
PERMIT #	NA		
MARKET AREA	12	ADDRESS	2515 VENTURA CIR
APPRAISER NAME	EWI	BRANCH OFFICE	PALM BAY

IMPROVEMENTS SKETCH

EST FROM PICTOMETRY

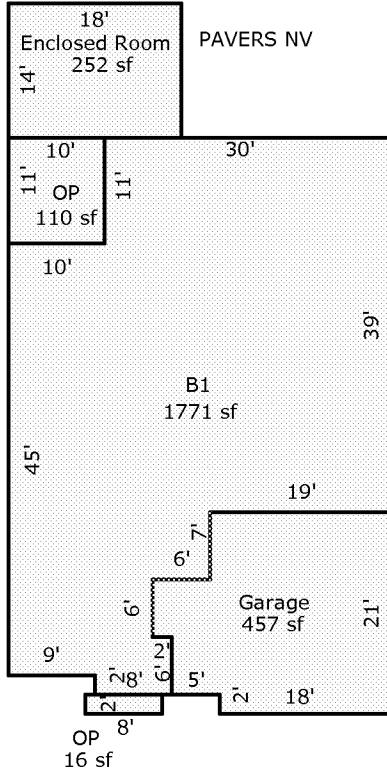

Scale: 1 = 20

AREA CALCULATIONS

AREA CALCULATIONS SUMMARY

Code	Description	Factor	Net Size	Perimeter	Net Totals
B1	B1	1.00	1771	200	1771
GA	Garage	1.00	457	92	457
OP	OP	1.00	16	20	
	OP	1.00	110	42	126
ENCLR	Enclosed Room	1.00	252	64	252

Comment Table 1

--	--

Comment Table 2

Comment Table 3

--	--