

# SKETCH/AREA TABLE ADDENDUM

DATE 1/25/10

RE # 2852723

PARCEL ID 28 370775 B. 14.

CITY W. MELBOURNE

COUNTY BREVARD

STATE FL

ZIP 32904

PERMIT # NA

MARKET AREA 12

ADDRESS 2526 VENTURA CIR

APPRAISER NAME EWI

BRANCH OFFICE PALM BAY

SUBJECT

IMPROVEMENTS SKETCH

EST FROM PICTOMETRY

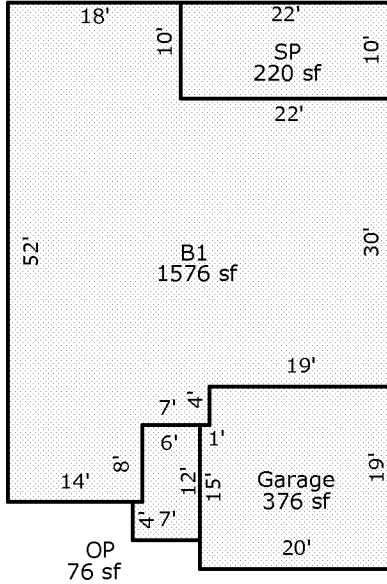

Scale: 1 = 20

AREA CALCULATIONS

### AREA CALCULATIONS SUMMARY

Code	Description	Factor	Net Size	Perimeter	Net Totals
B1	B1	1.00	1576	184	1576
GA	Garage	1.00	376	78	376
OP	OP	1.00	76	38	76
SP	SP	1.00	220	64	220

#### Comment Table 1

--	--

#### Comment Table 2

#### Comment Table 3

--	--