

SKETCH/AREA TABLE ADDENDUM

DATE 12/3/10

RE # 2836285

SUBJECT	PARCEL ID 28-37-28-JO-13-4
	CITY PALM BAY COUNTY BREVARD STATE FL ZIP 32905
	PERMIT # N
	MARKET AREA 14 ADDRESS 969 NE WAIALAE CIR
	APPRAISER NAME PHK BRANCH OFFICE PALM BAY

IMPROVEMENTS SKETCH

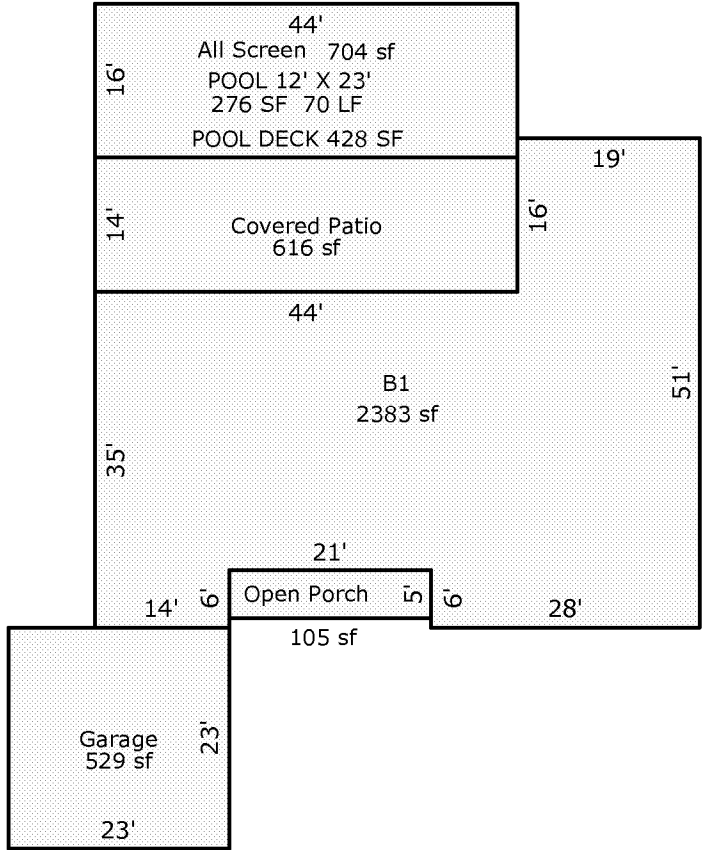

Scale: 1 = 20

AREA CALCULATIONS

AREA CALCULATIONS SUMMARY

Code	Description	Factor	Net Size	Perimeter	Net Totals
B1	B1	1.00	2383	240	2383
GA	Garage	1.00	529	92	529
OP	Open Porch	1.00	105	52	105
ALSCN	All Screen	1.00	704	120	704
CVPRT	Covered Patio	1.00	616	116	616

Comment Table 1

--	--

Comment Table 2

Comment Table 3

--	--