

# SKETCH/AREA TABLE ADDENDUM

DATE 4/26/10

RE # 2835795

SUBJECT

PARCEL ID 28-37-27-75-123-2			
CITY PALM BAY	COUNTY BREVARD	STATE FL	ZIP 32905
PERMIT # N			
MARKET AREA 14	ADDRESS 2038 NE BRADWAY ST		
APPRAISER NAME PHK	BRANCH OFFICE PALM BAY		

IMPROVEMENTS SKETCH

SHED N/V

NO F/C ALL ESTIMATED W/PICTOMETRY

WOOD DECK 320 SF EST

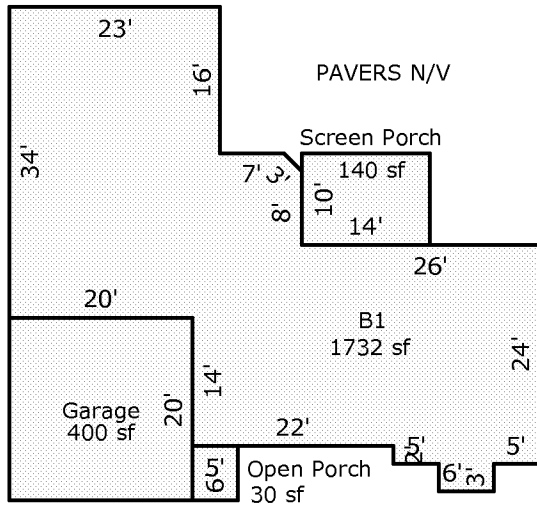

PAVERS N/V

Screen Porch

B1  
1732 sf

Garage  
400 sf

Open Porch  
30 sf

Scale: 1 = 21

AREA CALCULATIONS

### AREA CALCULATIONS SUMMARY

Code	Description	Factor	Net Size	Perimeter	Net Totals
B1	B1	1.00	1732	221	1732
GA	Garage	1.00	400	80	400
OP	Open Porch	1.00	30	22	30
SP	Screen Porch	1.00	140	48	140

Comment Table 1

Comment Table 2

Comment Table 3