

SKETCH/AREA TABLE ADDENDUM

Parcel No 5/14/09

File No 2812686

Property Address 283634FB1903 7

City PALM BAY

County BREVARD

State FL

Zip 32907

Owner N

Client 14

Client Address 1350 SEQUOIA RD NW

Appraiser Name PHK

Inspection Date PALM BAY

NO F/C ALL ESTIMATED W/PICTOMETRY

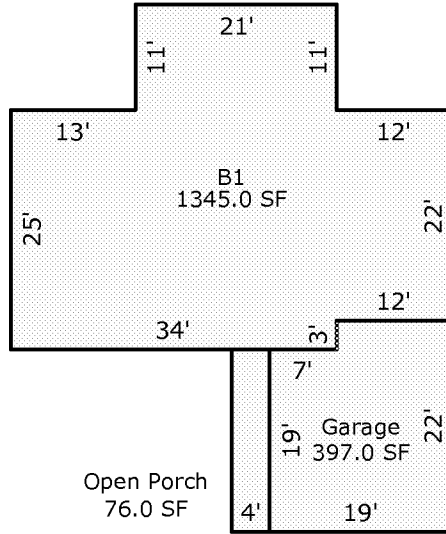

Scale: 1 = 20

AREA CALCULATIONS SUMMARY

Code	Description	Factor	Net Size	Perimeter	Net Totals
B1	B1	1.00	1345.0	164.0	1345.0
GA	Garage	1.00	397.0	82.0	397.0
OP	Open Porch	1.00	76.0	46.0	76.0

Comment Table 1

--

Comment Table 2

Comment Table 3

--	--