

SKETCH/AREA TABLE ADDENDUM

Parcel No 12/11/08

File No 2810504

Property Address 28-36-28-KN-1806-4

City PALM BAY

County BREVARD

State FL

Zip 32907

Owner PB0105981

Client 014

Client Address 1654 HEARTWELLVILLE ST NW

Appraiser Name PHK

Inspection Date PALM BAY

NO F/C ALL ESTIMATED W/PICTOMETRY

WDECK N/V

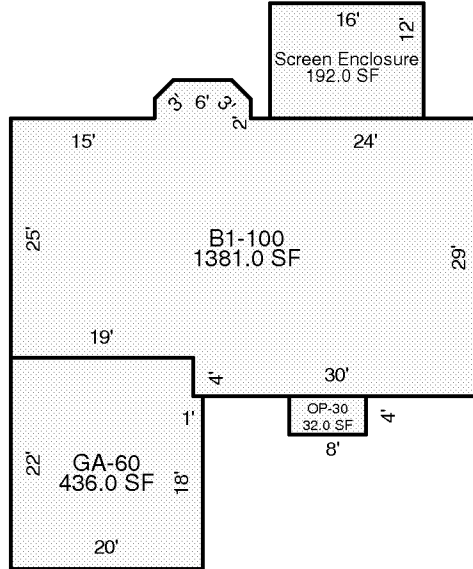

Scale: 1 = 20

AREA CALCULATIONS SUMMARY

Code	Description	Factor	Net Size	Perimeter	Net Totals
B1	B1-100	1.00	1381.0	161.7	1381.0
SCREEN	Screen Enclosure	1.00	192.0	56.0	192.0
GA7	GA-60	1.00	436.0	84.0	436.0
OP4	OP-30	1.00	32.0	24.0	32.0

AREA CALCULATIONS